

How many watts of power are sufficient for a general base station



Overview

It depends on your devices and usage—but most users require 300W to 2,000W for reliable power. Distance is usually within a mile or two, there's a ~7watt repeater about 3 miles away up high with 6. It seems that the term "fixed station" is no longer defined by the new rules, so that 15 watt limit seems meaningless. It appears that. The maximum transmitting power depends on which channels are being used and the type of station. Each GMRS transmitter type must be. Blender: 300 running watts, 650 starting watts. Categories of Power Solutions The guide helps you compare different types of power sources, including fuel-powered generators and battery. With capacities ranging from 200Wh to over 5000Wh and power outputs from 300W to 4000W, the choices can be overwhelming. Imagine being halfway through a camping trip when your fridge and phone die, or losing work during a blackout because your laptop battery drained.

How many watts of power are sufficient for a general base station



eCFR :: 47 CFR 95.1767 -

(1) The transmitter output power of mobile, repeater and base stations must not exceed 50 Watts. (2) The transmitter output power of fixed stations must not exceed 15 Watts. (b) 462 MHz interstitial ...

[Learn More](#)

What Size Portable Power Station Do I Need? February 2026 Guide

Most people need a 500-1000 watt-hour unit for camping and small emergencies, while home backup typically requires 1500-3000 watt-hours or more. Let me walk you through exactly how ...



[Learn More](#)

- LiFePO₄
- Wide temp: -20°C to 55°C
- Easy to expand
- Floor mount&wall mount
- Intelligent BMS
- Cycle Life:≥6000
- Warranty :10 years



Quick Reference Wattage Guide: A Must-Have Resource for Emergency Power

Sum Up Your Wattages: Use the guide's quick reference table to calculate total running and starting watts. Select the Right Generator: Choose a generator that comfortably supports your ...

[Learn More](#)

Power Station Calculator

A: For basic emergency needs (lights, phone charging, small appliances), a 500-1000Wh power station is typically sufficient for 1-3 days. Calculate exact runtime and recharge times for any power station. ...

[Learn More](#)



Maximum Wattage?

As found on page 70 of the GMRS rules (1): (1) The ...

[Learn More](#)

What's enough power for a base station? : r/gmrs

Like on the 2m band I'd say 50 watts is plenty, 75 watts is a hell of a lot, and 100 watts is for high up repeaters with important jobs. Just my own \$0.02 on that but it tracks with my experience.

[Learn More](#)



How Many Watts Do I Need for a Portable Power Station

Determining the right wattage for your portable power station requires understanding both continuous power needs and startup surges. Most devices



list their wattage on labels or manuals,
...

[Learn More](#)

How to Size a Portable Power Station

Luckily, there are formulas to help. Here are all the tools you need to help you find the right size portable power station for your needs.

[Learn More](#)

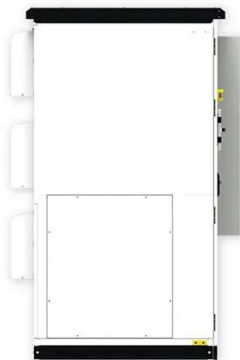
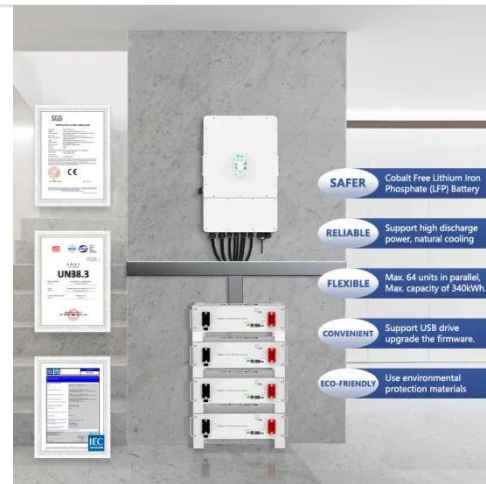

What Size Portable Power Station Do I Need? W/Wh Calculator & Guide

Stop guessing the size! Use our free calculator to determine the exact Watts (W) and Battery Capacity (Wh) you need for your portable power station or solar generator. Perfect for camping, RVs, and
...

[Learn More](#)

Home Backup Power Sizing Guide , WhichWatts

Learn how to size a home backup power system correctly. Calculate your energy needs and choose the right capacity for

emergency power.

[Learn More](#)



Contact Us

For catalog requests, pricing, or partnerships, please visit:
<https://www.v4venison.co.za>

