

Generation to substation



Generation to substation



How It Works: Electric Transmission & Distribution and Protective ...

The focus of this primer is on the transmission and distribution segments: the power lines, substations, and other infrastructure needed to move power from generation sources to end users.

[Learn More](#)

Substation-Sited Generation: A New Frontier for Utility Resilience and

For rural electric cooperatives, municipal power systems, and even investor-owned utilities seeking flexible capacity solutions, substation-sited generation offers a compelling value proposition



[Learn More](#)

Fundamentals of Modern Electrical Substations

All substation elements (transformers, breakers, disconnecting switches etc.) should be electrically connected in accordance with a planned substation arrangement.

[Learn More](#)

Types of Electrical Substations and Functions



As the demand for electrical power continues to grow, it can be met through power generation substations. There are different types of power generation substations, including thermal, nuclear, ...

[Learn More](#)



Understanding the Role of Substations Along the Transmission Path

This article examines the functions of four different types of substations within the electrical grid: step-up, step-down, transmission, and distribution.

[Learn More](#)

Substation-Sited Generation: A New Frontier for Utility Resilience and

For decades, utilities have deployed distributed generation along distribution circuits primarily for single-circuit capacity support and voltage regulation. While these applications remain ...

[Learn More](#)

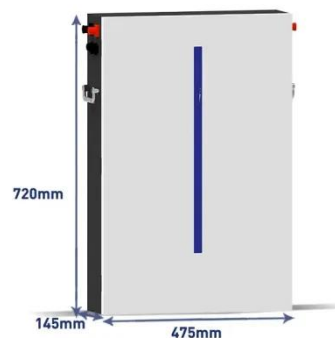

Distribution Substations

An electrical substation is a subsidiary station of an electricity generation, transmission and distribution system where voltage is transformed from high to low or the reverse using transformers.

[Learn More](#)

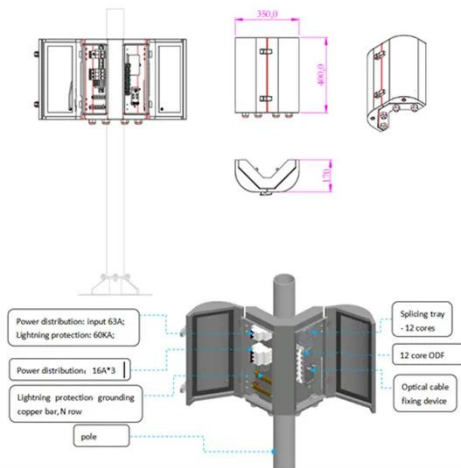

Substation configuration and build types , National Grid

Each substation, whether existing or new, can have different configurations or equipment construction depending on what is needed, and to comply with regulations.

[Learn More](#)



Electric Transmission

Electric power transmission is the bulk transfer of electrical energy from generating power plants to electrical substations. Electricity is transported over long distances at high voltages, which minimizes ...

[Learn More](#)



Understanding Grid Stations, Substations, and Switchyards in Power ...

For energy developers, understanding the distinctions between grid stations, substations, and switchyards in power

systems is essential to effectively plan and manage energy infrastructure.

[Learn More](#)



Contact Us

For catalog requests, pricing, or partnerships, please visit:
<https://www.v4venison.co.za>

